

A018N

SPECIFICATION SHEET

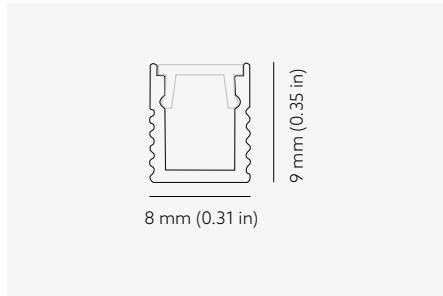

Project

Date

Quantity

Notes

ORDER CODE

MODEL	SEGMENT	WIRE EXIT	LED ALIGN	COLOR	COVER	LED SOURCE	WATTAGE	CRI	CCT	SEGMENT LENGTH	CONNECTOR
A018N											

SEGMENT	L	S	M	E	F
	Individual	start	middle	end	full

WIRE EXIT	E	B	S
	end	back	side

LED ALIGN	C	L	R
	center	left	right

COLOR	AGY	PWE	PBK	CUSTOM
	anodized gray	painting white	painting black	contact sales

COVER	PRM.A018N.C01.OPL opal
-------	---------------------------

LED SOURCE	FL175/Nx G4	FL175/Dx G4
	static white	static white
cutting increment	40 mm (1.57")	40 mm (1.57")

WATTAGE	4	9	14
	4,8 W/m 1.5 W/ft	9,6 W/m 2.9 W/ft	14,4 W/m 4.4 W/ft
	static white	static white	static white

CRI	8	9	0
	CRI 80+	CRI 90+	CRI 95+

CCT	20	22	25	27	30	35	40	50	57	65
	2000K	2200K	2500K	2700K	3000K	3500K	4000K	5000K	5700K	6500K
	*for Nx LED strip only		*for Nx LED strip only							

SEGMENT LENGTH	For 40mm (1.57") LED strip cutting increment																							
in	1.6"	3.1"	4.7"	6.3"	7.8"	9.4"	11"	1' 0.5"	1' 2.1"	1' 3.7"	1' 5.3"	1' 6.8"	1' 8.4"	1' 10"	1' 11.6"	2' 1.2"	2' 2.77"	2' 5.9"	2' 0"	2' 7.4"	2' 9"	2' 10"	3' 0.2"	3' 1.7"
mm	40	80	120	160	200	240	280	320	360	400	440	480	520	560	600	640	680	720	760	800	840	880	920	960
in	3' 3.3"	3' 4.9"	3' 6.5"	3' 8"	3' 9.6"	3' 11"	4' 0.8"	4' 2.4"	4' 3.9"	4' 5.5"	4' 7.1"	4' 8.6"	4' 10"	4' 11"	5' 1.4"	5' 2.9"	5' 4.5"	5' 6.1"	5' 7.7"	5' 9.2"	5' 10.1"	6' 0.4"	6' 2"	6' 3.5"
mm	1000	1040	1080	1120	1160	1200	1240	1280	1320	1360	1400	1440	1480	1520	1560	1600	1640	1680	1720	1760	1800	1840	1880	1920
in	6' 5.1"	6' 6.7"																						
mm	1960	2000																						

CONNECTOR	NON	PH1
	no connectors	connector



COVERS

PRG.A018N.C01.OPL

opal



BRACKETS

PRG.A018N.F01.GZK

metal

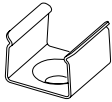

WIRE

E - END EXIT WIRE

wire comes out from profile through endcap

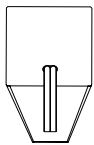

B - BACK EXIT WIRE

wire through a hole on the back of the profile

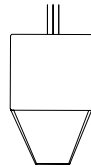

SEGMENTS

INDIVIDUAL LUMINAIRE

Comes as individual luminaire with a connection to the power supply.

L - LUMINAIRE



Endcaps on both ends
Input wire with male connector, no output wire
Module length = **LENGTH** + 8 mm / 0,31"
(back wire exit)
Module length = **LENGTH** + 11mm / 0.43"
(end wire exit)

CONTINUOUS LINE

Connecting LED modules to a continuous line, no connection mark is visible between the modules.

S - START MODULE



Endcap on single end only
Input wire with male connector, output with female
Module length = **LENGTH** + 5 mm (0,19")

M - MIDDLE MODULE



No endcaps on both ends
Input wire with male connector, output with female
Module length = **LENGTH** + 2 mm (0,07")

E - END MODULE



Endcap on single end only
Input wire with male connector, no output cable
Module length = **LENGTH** + 5 mm (0,19")

FULL SET INSTALLATION

Connecting the LED module to a line connection endcaps are visible, no continuous light line is obtained.

F - FULL SET MODULE



Endcap on both ends
Input wire with male connector, output female
Module length = **LENGTH** + 8 mm / 0,31" back, (side wire exit)
Module length = **LENGTH** + 14 mm / 0.55" (end wire exit)

F - FULL SET MODULE



L - LUMINAIRE or **F - FULL SET MODULE**



WIRE

PH1M - MALE CONNECTOR
for indoor use only

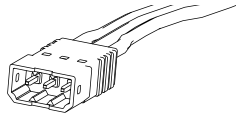

PH1F - FEMALE CONNECTOR
for indoor use only

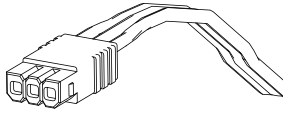

NON - NO CONNECTORS (LEAD WIRES END)
any connector can be applied

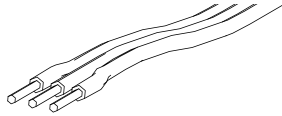

CONNECTOR DIMENSIONS		MALE		FEMALE	
WHITE 2-PIN	Length	0.61"	15.5 mm	0.59"	15 mm
	Width	0.263"	6.7 mm	0.24"	6.1 mm
	Height	0.196"	5 mm	0.196"	5 mm
TW 3-PIN	Length	0.61"	15.5 mm	0.59"	15 mm
	Width	0.362"	9.2 mm	0.338"	8.6 mm
	Height	0.196"	5 mm	0.196"	5 mm
RGB 4-PIN	Length	0.61"	15.5 mm	0.59"	15 mm
	Width	0.648"	16.5 mm	0.437"	11.1 mm
	Height	0.204"	5.2 mm	0.196"	5 mm
RGBW 5-PIN	Length	0.61"	15.5 mm	0.59"	15 mm
	Width	0.559"	14.2 mm	0.535"	13.6 mm
	Height	0.196"	5 mm	0.196"	5 mm

LEAD CABLES

Lead-wire cables are used to connect the LED module to the power supply unit.

FOR WHITE LEDS
HR 2PIN P1M.NON LXXX



FOR WHITE LEDS
HR 2PIN P1M.P1F LXXXX



FOR TUNABLE WHITE LEDS
HR 3PIN P1M.NON LXXX



FOR TUNABLE WHITE LEDS
HR 3PIN P1M.P1F LXXXX



FOR RGB LEDS
HR 4PIN P1M.NON LXXX



FOR RGB LEDS
HR 4PIN P1M.P1F LXXXX



FOR RGB+W LEDS
HR 5PIN P1M.NON LXXX



FOR RGB+W LEDS
HR 5PIN P1M.P1F LXXXX



EXTENSION CABLES LENGTHS

LXXX	L200	L1000	L2000	L5000	L9000
LENGTH	200 mm 7.9 in	1000 mm 3 ft 3 in	2000 mm 6 ft 6 in	5000 mm 16 ft 4 in	9000 mm 29 ft 5 in

Possible allowed deviation of optical and electrical values are ±15%. Allowed measurement uncertainty ±7%.
All values in datasheet are for reference only and customers should take these values on their own risk. Holectron reserves the right for changes without prior notice.
www.holectron.com | Customizable Linear LED Lighting Products

LUMEN VALUES OF LED STRIPS

FL175/DX G4 - WHITE LIGHT

CRI 80+		POWER					
		4,8 W/m		9,6 W/m		14,4 W/m	
SPECTRUM	KELVINS	1.5 W/ft	2.9 W/ft	4.4 W/ft	4.4 W/ft	4.4 W/ft	4.4 W/ft
		4	9	14	14	14	14
		lm/m	lm/ft	lm/m	lm/ft	lm/m	lm/ft
822	2200K	574	175	1125	343	1668	508
827	2700K	653	199	1280	390	1896	577
830	3000K	653	199	1280	390	1896	577
835	3500K	692	211	1358	414	2011	612
840	4000K	692	211	1358	414	2011	612
850	5000K	732	223	1436	437	2126	647
857	5700K	732	223	1436	437	2126	647
865	6500K	732	223	1436	437	2126	647
EFFICACY		153 lm/W		150 lm/W		148 lm/W	



CRI 90+		POWER					
		4,8 W/m		9,6 W/m		14,4 W/m	
SPECTRUM	KELVINS	1.5 W/ft	2.9 W/ft	4.4 W/ft	4.4 W/ft	4.4 W/ft	4.4 W/ft
		4	9	14	14	14	14
		lm/m	lm/ft	lm/m	lm/ft	lm/m	lm/ft
922	2200K	461	141	923	281	1375	419
T927	2700K	682	208	1347	410	1995	607
T930	3000K	682	208	1365	416	2030	618
T935	3500K	700	213	1365	416	2030	618
T940	4000K	700	213	1400	426	2082	634
T950	5000K	700	213	1400	426	2082	634
T957	5700K	700	213	1365	416	2030	618
T965	6500K	700	213	1365	416	2030	618
EFFICACY		146 lm/W		146 lm/W		145 lm/W	

LUMEN VALUES OF LED STRIPS

FL175/NX G4 - WHITE LIGHT

CRI 80+		POWER					
		4,8 W/m		9,6 W/m		14,4 W/m	
SPECTRUM	KELVINS	4	9	14	4,8 W/m	9,6 W/m	14,4 W/m
		lm/m	lm/ft	lm/m	lm/ft	lm/m	lm/ft
820	2000K	487	148	988	301	1501	457
822	2200K	527	160	1069	326	1625	495
825	2500K	577	176	1171	357	1778	541
827	2700K	675	206	1369	417	2080	633
830	3000K	695	212	1410	429	2142	652
835	3500K	711	216	1442	439	2191	667
840	4000K	713	217	1446	440	2197	669
850	5000K	790	241	1574	479	2347	715
857	5700K	762	232	1519	463	2265	690
865	6500K	762	232	1519	463	2265	690
EFFICACY		165 lm/W		164 lm/W		163 lm/W	



CRI 90+		POWER					
		4,8 W/m		9,6 W/m		14,4 W/m	
SPECTRUM	KELVINS	4	9	14	4,8 W/m	9,6 W/m	14,4 W/m
		lm/m	lm/ft	lm/m	lm/ft	lm/m	lm/ft
920	2000K	426	130	847	258	1261	384
922	2200K	461	141	917	280	1364	416
925	2500K	500	152	994	303	1480	451
T927	2700K	702	214	1399	426	2086	635
T930	3000K	738	225	1470	448	2192	667
T935	3500K	757	231	1507	459	2248	685
T940	4000K	767	234	1528	465	2279	694
T950	5000K	769	234	1533	467	2287	696
T957	5700K	742	226	1479	450	2207	672
T965	6500K	742	226	1479	450	2207	672
EFFICACY		160 lm/W		160 lm/W		159 lm/W	

CRI 95+		POWER					
		4,8 W/m		9,6 W/m		14,4 W/m	
SPECTRUM	KELVINS	4	9	14	4,8 W/m	9,6 W/m	14,4 W/m
		lm/m	lm/ft	lm/m	lm/ft	lm/m	lm/ft
027	2700K	491	150	979	298	1460	445
030	3000K	502	153	1001	305	1492	454
035	3500K	513	156	1022	311	1524	464
040	4000K	519	158	1035	315	1544	470
050	5000K	555	169	1107	337	1653	503
EFFICACY		116 lm/W		115 lm/W		115 lm/W	

Possible allowed deviation of optical and electrical values are ±15%. Allowed measurement uncertainty ±7%.
 All values in datasheet are for reference only and customers should take these values on their own risk. Holectron reserves the right for changes without prior notice.
www.holectron.com | Customizable Linear LED Lighting Products

POWER CONSUMPTION PER FIXTURE LENGTH

LENGTH		4,8 W/m	1.5 W/ft	9,6 W/m	2.9 W/ft	14,4 W/m	4.4 W/ft
		4		9		14	
4.9"	125 mm	0.6	0.2	1.2	0.4	1.8	0.5
7.4"	188 mm	0.9	0.3	1.8	0.5	2.7	0.8
9.8"	250 mm	1.2	0.4	2.4	0.7	3.6	1.1
1'	313 mm	1.5	0.5	3.0	0.9	4.5	1.4
1' 2"	375 mm	1.8	0.5	3.6	1.1	5.4	1.6
1' 5"	438 mm	2.1	0.6	4.2	1.3	6.3	1.9
1' 7"	500 mm	2.4	0.7	4.8	1.5	7.2	2.2
1' 10"	563 mm	2.7	0.8	5.4	1.6	8.1	2.5
2'	625 mm	3.0	0.9	6.0	1.8	9.0	2.7
2' 3"	688 mm	3.3	1.0	6.6	2.0	9.9	3.0
2' 5"	750 mm	3.6	1.1	7.2	2.2	10.8	3.3
2' 8"	813 mm	3.4	1.0	6.8	2.1	10.3	3.1
2' 10"	875 mm	4.2	1.3	8.4	2.6	12.6	3.8
3'	938 mm	4.5	1.4	9.0	2.7	13.5	4.1
3' 3"	1000 mm	4.8	1.5	9.6	2.9	14.4	4.4
3' 5"	1063 mm	5.1	1.6	10.2	3.1	15.3	4.7
3' 8"	1125 mm	5.4	1.6	10.8	3.3	16.2	4.9
3' 10"	1188 mm	5.7	1.7	11.4	3.5	17.1	5.2
4' 1"	1250 mm	6.0	1.8	12.0	3.7	18.0	5.5
4' 3"	1313 mm	6.3	1.9	12.6	3.8	18.9	5.8
4' 6"	1375 mm	6.6	2.0	13.2	4.0	19.8	6.0
4' 8"	1438 mm	6.9	2.1	13.8	4.2	20.7	6.3
4' 11"	1500 mm	7.2	2.2	14.4	4.4	21.6	6.6
5' 1"	1563 mm	7.5	2.3	15.0	4.6	22.5	6.9
5' 4"	1625 mm	7.8	2.4	15.6	4.8	23.4	7.1
5' 6"	1688 mm	8.1	2.5	16.2	4.9	24.3	7.4
5' 9"	1750 mm	8.4	2.6	16.8	5.1	25.2	7.7
5' 11"	1813 mm	8.7	2.6	17.4	5.3	26.1	7.9
6' 2"	1875 mm	9.0	2.7	18.0	5.5	27.0	8.2
6' 4"	1938 mm	9.3	2.8	18.6	5.7	27.9	8.5
6' 6"	2000 mm	9.6	2.9	19.2	5.8	28.8	8.8

Possible allowed deviation of optical and electrical values are $\pm 15\%$. Allowed measurement uncertainty $\pm 7\%$.

All values in datasheet are for reference only and customers should take these values on their own risk. Holectron reserves the right for changes without prior notice.

www.holectron.com | Customizable Linear LED Lighting Products

POWER SUPPLIES

POWER SUPPLY MEANWELL PWM-40W 24V IP67

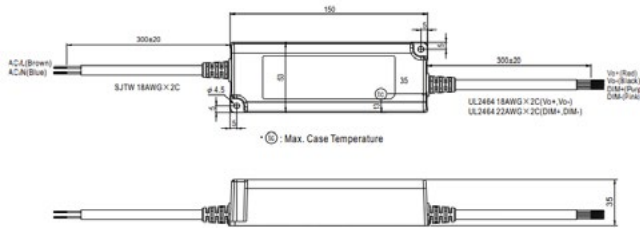

Order code	DRI.V24.OCO.FO.MW.00043
Rated supply voltage	115 - 277 V AC
AC voltage range	90 - 305 V AC
Output voltage	24 V DC
Output power	40 W
Dimming	0-10 V / PWM
IP class	IP67

POWER SUPPLY MEANWELL PWM-60W 24V IP67

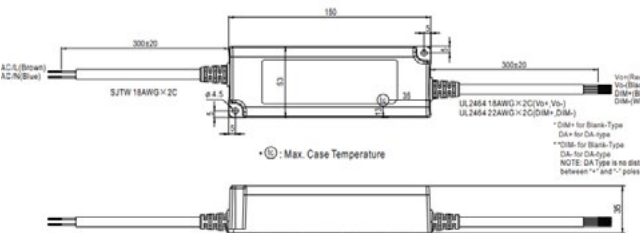

Order code	DRI.V24.OCO.DA.MW.00012
Rated supply voltage	115 - 277 V AC
AC voltage range	90 - 305 V AC
Output voltage	24 V DC
Output power	60 W
Dimming	DALI
IP class	IP67

POWER SUPPLY MEANWELL PWM-90W 24V IP67

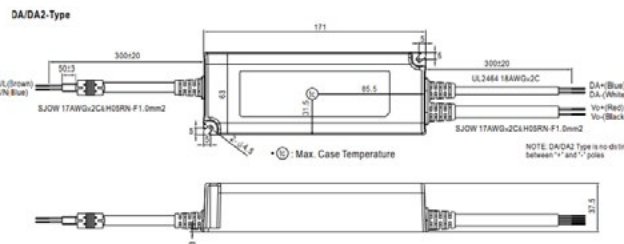

Order code	DRI.V24.OCO.DA.MW.00011
Rated supply voltage	115 - 277 V AC
AC voltage range	90 - 305 V AC
Output voltage	24 V DC
Output power	90 W
Dimming	DALI
IP class	IP67

POWER SUPPLY MEANWELL PWM-120W 24V IP67

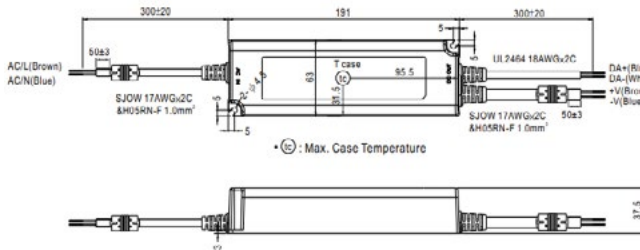

Order code	DRI.V24.OCO.DA.MW.00006
Rated supply voltage	115 - 277 V AC
AC voltage range	90 - 305 V AC
Output voltage	24 V DC
Output power	120 W
Dimming	DALI
IP class	IP67

POWER SUPPLY 100W 24V IP67

for outdoor and indoor use

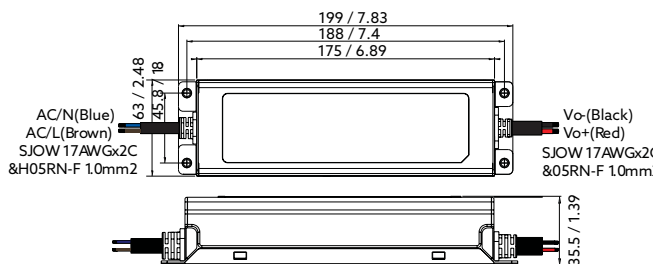

Order code	PSU MW ELG 100W 24V 5Y IP67 UL
Rated supply voltage	100-305 V 50/60 Hz
Output voltage	24 V DC
Output power	70 W (100-180 V AC) 96 W (200-305 V AC)
Dimming	non-dimmable
IP class	IP67

Possible allowed deviation of optical and electrical values are ±15%. Allowed measurement uncertainty ±7%.

All values in datasheet are for reference only and customers should take these values on their own risk. Holectron reserves the right for changes without prior notice.

POWER SUPPLY 150W 24V IP67

for outdoor and indoor use

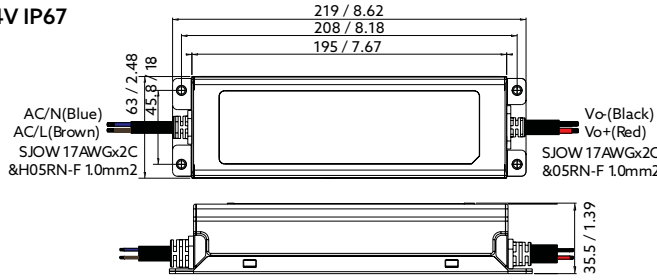

Order code	PSU MW ELG 150W 24V 5Y IP67 UL
Rated supply voltage	100-305 V 50/60 Hz
Output voltage	24 V DC
Output power	105 W (100-180 V AC) 150 W (200-305 V AC)
Dimming	non-dimmable
IP class	IP67

POWER SUPPLY MEANWELL PWM-200W 24V IP67

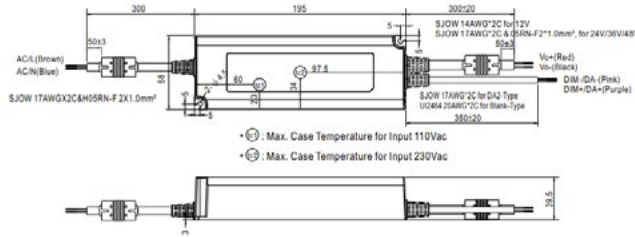

Order code	DRI.V24.OCO.DA.MW.00004
Rated supply voltage	115 - 277 V AC
AC voltage range	100 - 305 V AC
Output voltage	24 V DC
Output power	200 W
Dimming	DALI-2
IP class	IP67

POWER SUPPLY 40W 24V IP67 0-10V

with 0-10V dimming for outdoor and indoor use

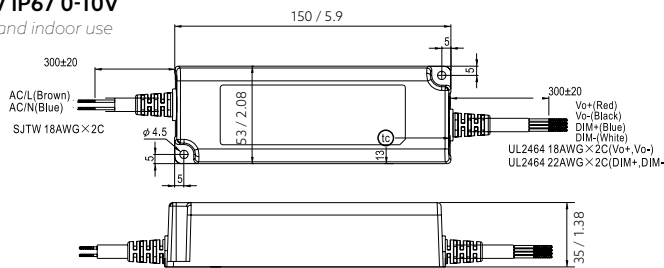

Order code	PSU MW PWM 40W 24V 5Y IP67 UL
Rated supply voltage	90-305 V 50/60 Hz
Output voltage	24 V DC
Output power	40 W
Dimming	0-10V
IP class	IP 67

POWER SUPPLY 60W 24V IP67 0-10V

with 0-10V / DALI dimming for outdoor and indoor use

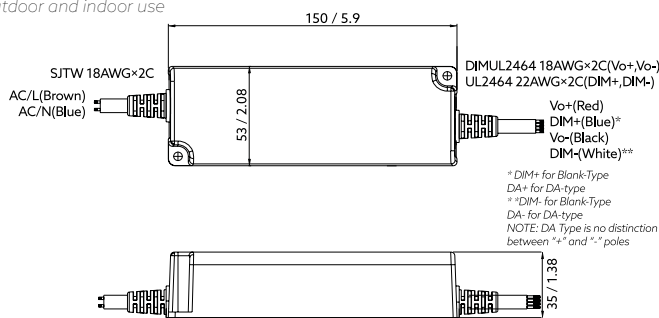

Order code	PSU MW PWM 60W 24V 5Y IP67 UL
Rated supply voltage	90-305 V 50/60 Hz
Output voltage	24 V DC
Output power	60 W
Dimming	0-10V / DALI
IP class	IP67

POWER SUPPLY 90W 24V IP67 0-10V

with 0-10V / DALI dimming for outdoor and indoor use

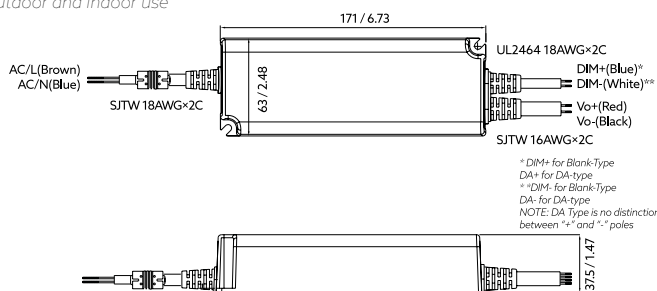

Order code	PSU MW PWM 90W 24V 5Y IP67 UL
Rated supply voltage	90-305 V 50/60 Hz
Output voltage	24 V DC
Output power	90 W
Dimming	0-10V / DALI
IP class	IP67

Possible allowed deviation of optical and electrical values are ±15%. Allowed measurement uncertainty ±7%.

All values in datasheet are for reference only and customers should take these values on their own risk. Holectron reserves the right for changes without prior notice.

POWER SUPPLY 120W 24V IP67 0-10V

with 0-10V / DALI dimming for outdoor and indoor use

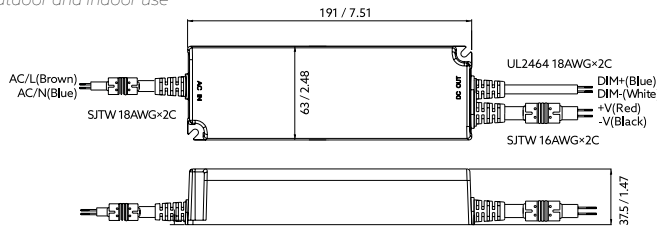

Order code	PSU MW PWM 120W 24V 5Y IP67 UL
Rated supply voltage	90-305 V 50/60 Hz
Output voltage	24 V DC
Output power	120 W
Dimming	0-10V / DALI
IP class	IP67

POWER SUPPLY 240W 24V IP67

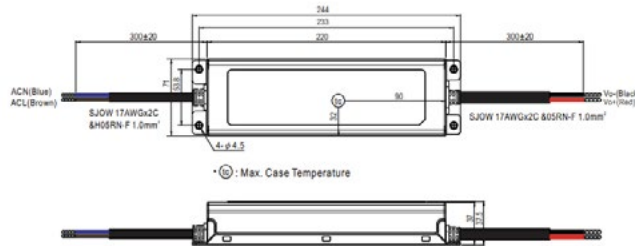

Order code	DRI.V24.OCO.FO.MW.00040
Rated supply voltage	115 - 277 V AC
AC voltage range	100 - 305 V AC
Output voltage	24 V DC
Output power	240 W
Dimming	no dimming
IP class	IP67

CONTROLLERS

WIRELESS BLUETOOTH

wireless controll using iOS or Android smartphones or tablets, for white, tunable white, RGB and RGB+W fixtures

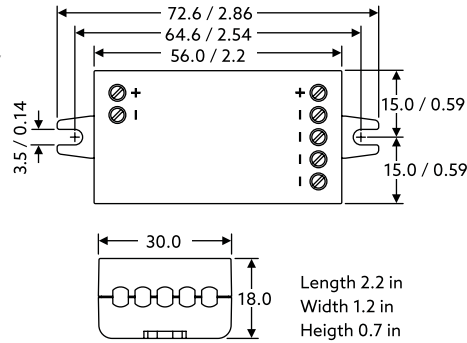

Order code	DIM-CA-BT/PWM4
Control type	Wireless Bluetooth BLE Control using iOS or Android phones or tablets
LED type	Single color, Tunable white, RGB, RGB+W
Input voltage	12-24 VDC
Input current max	6A or 4A (US and Canada)
Output voltage	Same as input voltage
Output current	6 A (can be freely divided between the channels) 4 A (US and Canada)
Dimming method	PWM
IP class	IP20

0-10V FOR TUNABLE WHITE

for tunable white fixtures

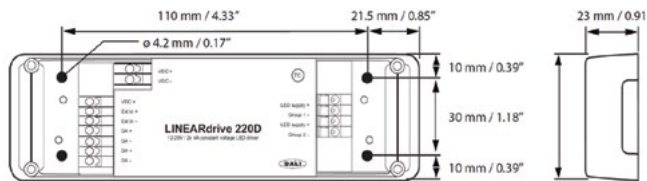

Order code	DIM EL 1-10V/TW
Control type	0-10V
LED type	Tunable white
Input voltage	12-24 VDC
Input current max	8 A, irrespective of PSU voltage
Output voltage	Same as input voltage
Output current	8 A maximum, irrespective of whether using one or both LED outputs
IP class	IP20

DMX/DALI FOR RGB+W

for white, tunable white, RGB and RGB+W fixtures



Length (L)	typical: 153 mm / 6.02 in
Width (W)	typical: 50 mm / 1.97 in
Height (H)	typical: 23 mm / 0.91 in
Weight	144 g

Order code	DIM EL DALI/RGBW
Control type	DMX and DALI
LED type	Single color, Tunable white, RGB, RGB+W
Input voltage	12-48 VDC
Input current max	24 A, irrespective of PSU voltage
Output voltage	Same as input voltage
Output current	RGBW @ 24V: 6A RGB @ 24V: 6A
IP class	IP20

DRIVER ENCLOSURES

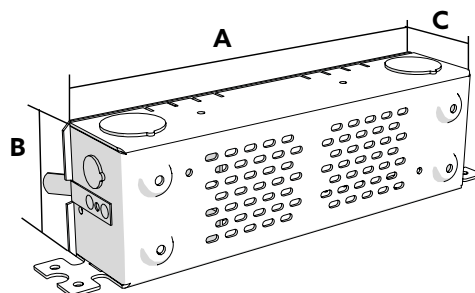

SIZE OPTIONS	A - LENGTH	C - HEIGHT	B - WIDTH
1	534 mm 21 inch	45 mm 1.7"	65 mm 2.6"
2	330 mm 13 inch	45 mm 1.7"	65 mm 2.6"

Possible allowed deviation of optical and electrical values are ±15%. Allowed measurement uncertainty ±7%.

All values in datasheet are for reference only and customers should take these values on their own risk. Holectron reserves the right for changes without prior notice.

INSTALLATION GUIDE

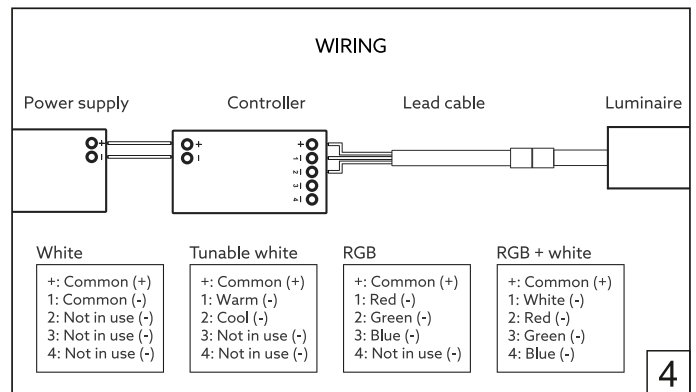
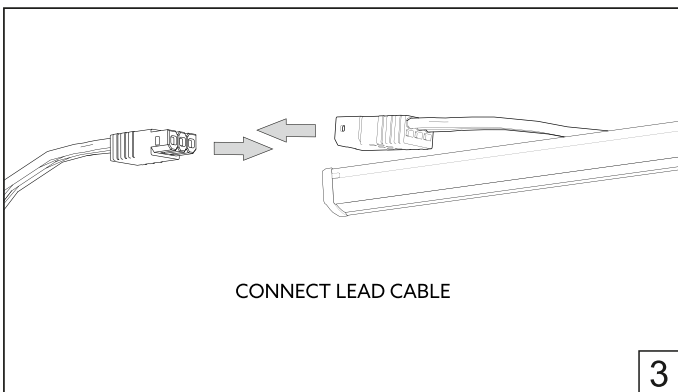
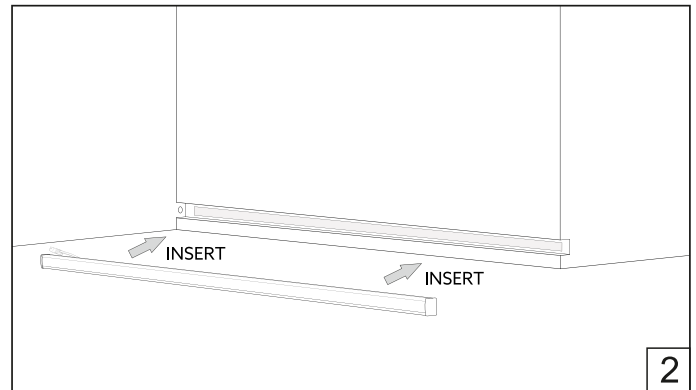
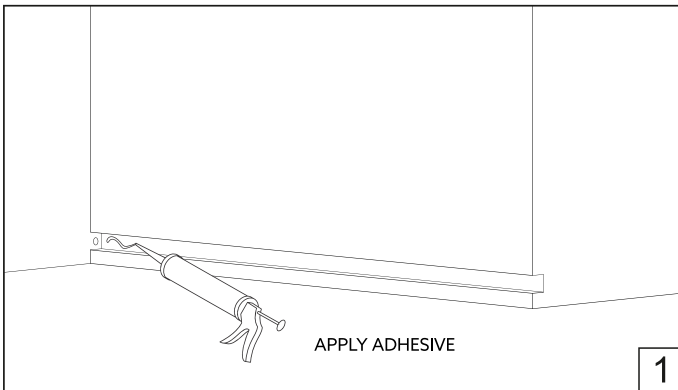

SAFETY / WARNINGS / DISCLOSURES

1. Install in accordance with national and local electrical code regulations.
2. Do not modify or disassemble this product beyond instructions or the warranty will be void.
3. Our channels, covers, end caps, and mounting brackets are also suitable for outdoor use with some considerations. Please consult with local Holecron representative to pick right fixtures for outdoor use.
4. Indoor (IP20) fixtures should never be mounted in areas receiving direct sunlight and locations where they can be submerged under water or might get in direct contact with water or puddling (rainfall, sprinkler, spray, etc.).
5. Avoid leaving gaps in any of the end cap or cover mating edges to the channel that will allow excess dust, debris, or water/moisture to enter the channel enclosure.
6. Actual product color may vary from what is pictured on this sheet and other print materials due to the limitations of photographic processes.
7. We reserve the right to modify and improve the design of our fixtures without prior notice. We cannot guarantee to match existing installed fixtures for subsequent orders or replacements in regards to product appearance, CCT, or lumen output.

SAFETY / WARNINGS / DISCLOSURES

Limited Warranty

This product has a five (5) year limited warranty from the date of shipment. This warranty does not include the additional accessories referenced in this specification sheet. Complete warranty details for fixtures and additional accessories are available online [download here](#). For warranty related questions please contact product support.

CONSUMER'S ACKNOWLEDGMENT

Holecron stands behind its products when they are used properly and according to our specifications. By purchasing our products, the purchaser agrees and acknowledges that lighting design, configuration and installation is a complex process, wherein seemingly minor factors or changes in layout and infield adjustments can have a significant impact on an entire system. Choosing the correct components is essential. Holecron is able to work with the original purchaser to make an appropriate product selection to the extent of the limited information that the customer can provide, but it is virtually impossible for Holecron to design a system that foresees every unknown factor. For this reason, this Warranty does not cover problems caused by improper design, configuration or installation issues.

Any statement from a Holecron employee or agent regarding a customer's bill of goods and/or purchase order is NOT an acknowledgment that the products

purchased are designed and configured correctly. The purchase agrees and acknowledges that it is the customer's responsibility to adhere strictly to all information contained in the Product Specification Sheets. There is often more than one way to design, configure and layout an LED lighting application properly to achieve the same lighting effect. Holecron strongly recommends that licensed professionals be used in the design and installation of lighting systems that include Holecron products. The specifications include important information that a designer and installer should carefully review and strictly follow. Qualified designers and certified and/or licensed installers, with access to the final installation environment, customer goals, and Holecron product specifications can make the requisite decisions appropriate for a successful finished lighting application.

HOLECTRON

HOLECTRON. All rights reserved.
Specifications are subject to change without notice.
Phone: +370 612 42446
email: info@holecron.com | www.holecron.com